

2018 MEMORIAL HEALTH FUND GRANT INFORMATION SESSION

May 11 & 14, 2018



Memorial Health Fund

A legacy of care for York.

Affiliated with York County Community Foundation

Housekeeping

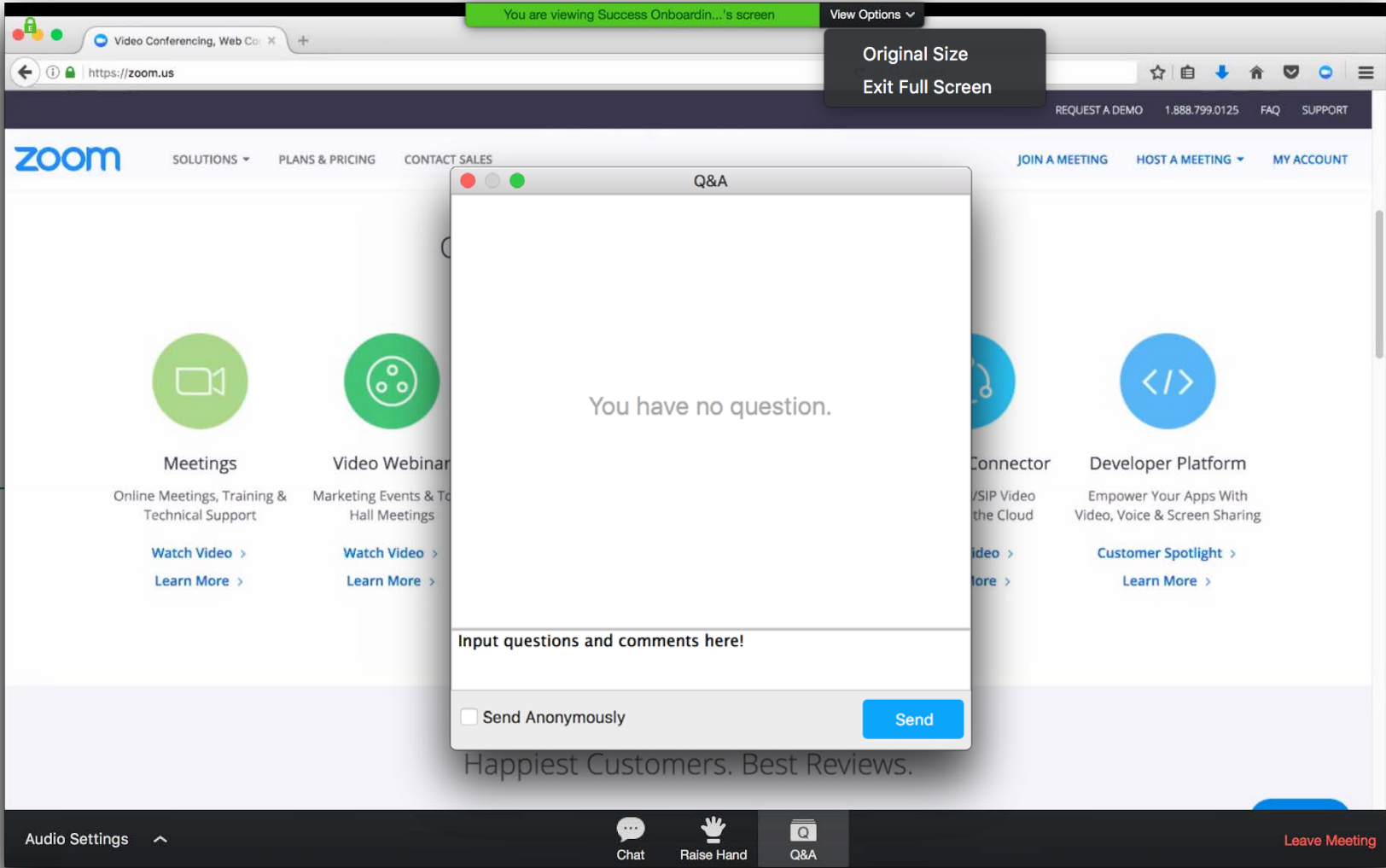

Agenda

- What is the Memorial Health Fund?
- NEW for 2018
- How to Apply
- What Happens After Application is Received?
- Expectations of Grantees
- Q&A



Memorial Health Fund

Improve the complete physical, mental, and social well-being of the residents of York, PA.

Memorial Health Fund is a supporting organization of York County Community Foundation. Its board has the final say about all grant making decisions. Its work is supported by YCCF; its grant making is staffed by Lise Levin.

Memorial is particularly interested in grants that have high impact; provide broad visibility and recognition; are strategic; have potential to leverage other resources, involve high-capacity agencies; yield measurable results; are sustainable once funding ceases.



Focus of Grants to be Awarded

Purpose: Improve the complete physical, mental and social well-being of the residents of York County, Pennsylvania.

- Improve overall community health
- Provide resources for the restoration and maintenance of health
- Bring high-quality health care services to the greater York area
- Promote general health and wellness of persons in the greater York area
- Promote health education
- Engage in fundraising and related activities or programs
- Engage in other activities directly or indirectly including making grants to other nonprofit organizations to enable them to carry out these activities.



Preference



Preference for projects demonstrating collaboration & innovative approaches to persistent challenges

Grant Cycle Timeline

- **Grant Cycle Opens:** May 7
- **Grant Applications Due:** July 31
- **Questions emailed to applicants:** August 28
- **Second Draft Due:** September 14
- **Recipients Announced By:** November 12

- **Maximum Amount per Grant:** up to \$50,000*

*Please note: Larger grant requests must demonstrate commensurately larger impact.

*Full grant cycle timeline found on website at <http://www.yccf.org/memorial-health-fund/>



2018 MHF Grant Making



Grantee Eligibility

- Must be classified as a 501(c) (3) public charity under the Internal Revenue Code (this does not apply to government agencies or public school districts). Individuals are not qualified applicants.
- Must be a 501(c) (3) for at least one year.
- Must provide services directly to York County.
- Must have submitted a satisfactory post grant report from all previous grants from YCCF before applying for a subsequent grant.
- **Grants are NOT provided for:**
 - Endowments, budget shortfalls, debt retirement or association dues.
 - Sectarian religious programs.
 - Organizations with discriminatory employment or program practices.
 - Any form of direct financial assistance to individuals.
 - Reimbursement for programs, programs or items purchased before grant is awarded.



New for 2018 Grantmaking

1. Improved application
2. Tutorial video for application software
(<https://www.youtube.com/watch?v=lpznVNdzO2Y>)
3. “Tips for applying for a grants” videos (Playlist found here:
https://www.youtube.com/watch?v=P_YLH3VXuKM&list=PLNsPeWFE5gP9-2AGOImsv6SRyGFXsQIyK)
4. Grantmaking e-newsletters



How to Apply

- All grant applications must be submitted using our online grant system
- Visit www.yccf.org/Memorialhealthfund or click on the “Grant Login” link at the top of the YCCF website.
- If you need help creating an account, check out the tutorial video: <https://www.youtube.com/watch?v=lpznVNdzO2Y>



Applying for Grants

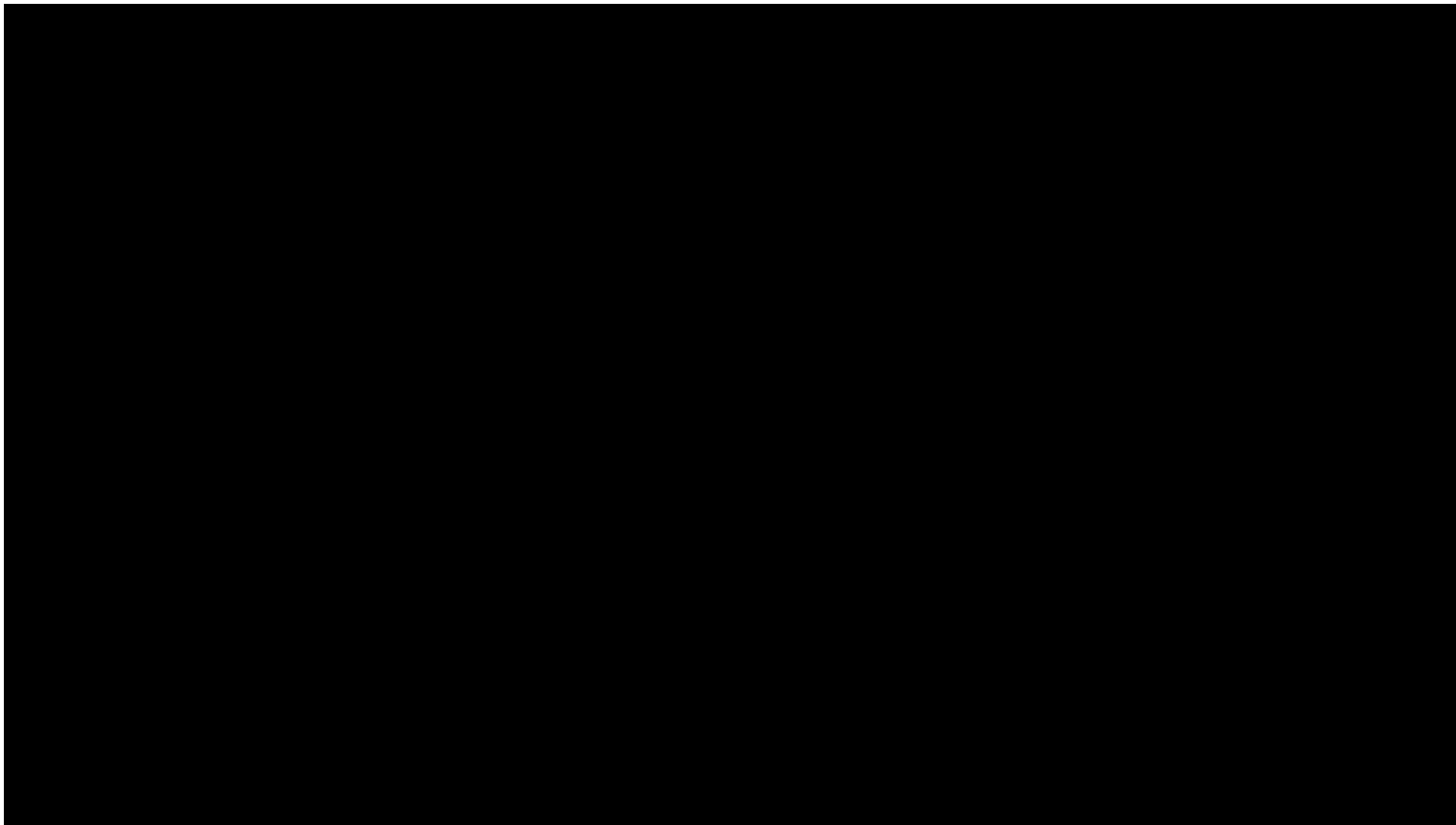

New to Us?

- Documents you'll want to start gathering now vs. later:
 - Audited financial statements OR current balance sheet & organizational budget with income and expenditures
 - Board of Directors list, with affiliations
 - IRS 501 c 3 letter
 - If you're using a fiscal sponsor, get their documents early

What Happens After Application Received?

MEMORIAL HEALTH FUND 2018 GRANT REVIEW RUBRIC						REVIEWER NAME: _____	
PROGRAM NAME: _____			ORGANIZATION: _____				
Criteria	Measure	Weak	Average	Strong			
PROGRAM DESIGN	• Program is consistent with agency mission	1	2	3	4	5	
	• Program is new or innovative approach to a community need	1	2	3	4	5	
	• Program design and action plan are feasible and understandable	1	2	3	4	5	
	• Program is consistent with funding priorities below	1	2	3	4	5	
	• Implementation timeline is reasonable	1	2	3	4	5	
PROGRAM IMPACT	• Target population is meaningful and appropriate	1	2	3	4	5	
	• <u>Program has</u> clear, understandable statement of need that aligns with program's outcomes & indicators	1	2	3	4	5	
	• Program will have appropriate and/or meaningful impact on the community and population served	1	2	3	4	5	
	• Program does not replicate existing services	1	2	3	4	5	
BUDGET	• Agency can carry out program and is prepared to take it on	1	2	3	4	5	
	• Budget is logical – proposed expenses & revenues are clear and feasible; (appropriate to total project cost; not subsidizing existing/operational expenses)	1	2	3	4	5	
OUTCOMES	• Program appears to be sustainable after MHF funding ends	1	2	3	4	5	
	• Program has measurable outcomes, indicators and evaluation criteria in place	1	2	3	4	5	
	• Program will have appropriate and/or meaningful impact that is positive and measurable	1	2	3	4	5	
TOTAL:		/70 <input type="checkbox"/>					

Reviewer Recommendation: **YES** **YES, PARTIAL \$_____** **MAYBE** **NO**

Comments:

MEMORIAL HEALTH FUND: Improving the complete physical, mental & social well-being of the residents of York, PA:

- Improve overall community health
- Provide resources for the restoration and maintenance of health
- Bring high-quality health care services to the greater York area
- Promote general health and wellness of persons in the greater York area
- Promote health education
- Engage in fundraising and related activities or programs
- Engage in other activities directly or indirectly including making grants to other nonprofit organizations to enable them to carry out these activities



Grantee Expectations: Changes to Your Grant Program

PLAN B

~~PLAN A~~

Interim Grant Reports

- Improve dialogue between MHF and you.
- Probably a 6 month check-in
 - That may change depending on your program
- Will be on Foundant
- Post-grant reports will also look similar, but longer



Workshop Grant Ideas Coming June 4 & 15

- June 4, 10 AM – 1 PM
- June 15, 10 AM – 1 PM
- Sign up here:

<https://www.signupgenius.com/go/60b0e4fafa729a1f85-memorial>



Memorial Health Fund



- [Grant Brochure](#)
- [MHF 2018 Application](#)
- [Rubric](#)
- This PP – available at <http://www.yccf.org/memorial-health-fund/>

